

Scarab
PRO



Read Guide Before Use

Important Safety Information

SAFETY TOPICS:

Read the Operation and Safety Guide and all of the safety precautions before attempting to operate WerkMaster Scarab Pro machine. Failure to follow the safety precautions could result in severe personal injury or death.

SAFETY CHECKLIST:

WARNING: ALWAYS turn the equipment off and unplug the power cord when changing discs/tooling, before servicing and when not in use.

1. Before connecting the equipment to a power source make sure it is the correct voltage.
2. Ensure all cords on the equipment are securely fastened and in good repair.
3. Ensure all extension cords and power outlets are rated for the intended use, are in good repair, and are properly grounded (3 prong configuration).
4. Never operate the equipment under the influence of drugs or alcohol or when extremely fatigued.
5. If the equipment doesn't start or stops while running contact the dealer.
6. Fully adhere dust skirt so that it barely touches the ground and that there are no cracks or splits in it, to ensure the dust stays contained under the machine

WARNING: Never turn the equipment on while it is tilted back. Any discs/tooling attached to the bottom could eject and become a lethal projectile.

Use this machine only in well-ventilated areas free from any flame, match or combustible materials.

Wear appropriate personal safety equipment such as hearing and eye protection and a dust mask or respirator.



Specifications

The Wet - Dry Polisher **Scarab Pro** is indented for professional use. Together with a tool appropriated for the corresponding application, it is made in order to grind, polish and smooth concrete, stone, terrazzo and hardwood.

Rated Voltage:	110 V
Rated Current:	15 A
Frequency:	60 Hz
Rated Speed:	1180 – 3380 rpm
Max. Diameter of the Tool:	3 in / 76 mm
Protection Class:	II
Degree of Protection:	IP 20
Weight:	16.5 lbs / 7.5 kg

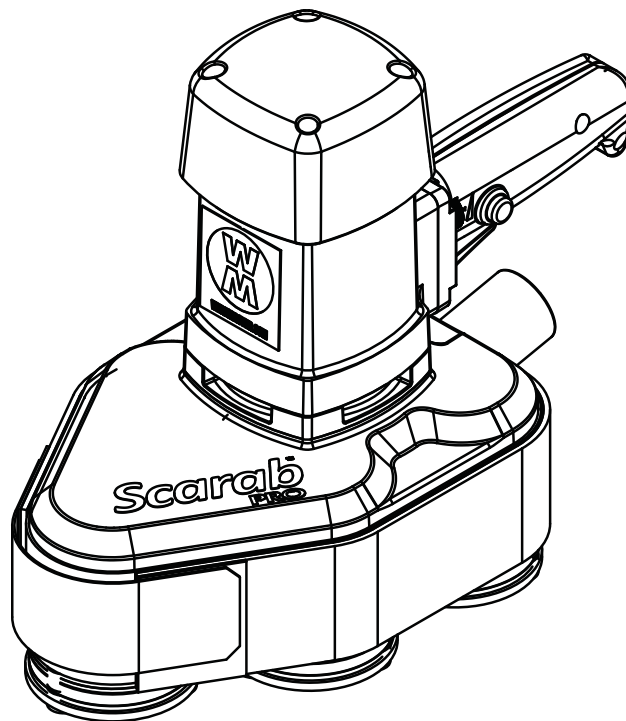



Portable Residual Current Device (PRCD)

- The (1) PRCD protective switch must **not** lay down in water.
- (1) PRCD protective switches must not be used to switch the tool on and off.
- Before starting your work, check the proper

Electrical Connection

- First, check the correspondence between voltage and frequency against the data mentioned on the identification plate. Voltage differences from + 6% to – 10% are allowed.
- The machine is equipped with a soft start which prevents that swift automatic circuit breakers are unintentionally triggered.
- The Scarab Pro is made in protection class II. The Scarab Pro is delivered with a (1) PRCD protective switch integrated in the cord to connect it with a socket.

Switch On/OFF and Speed Control

- To start the power tool, press the on/off switch (2)
- To stop the power tool, release the on/off switch (2)
- To adjust the speed, turn the dial (3) to your desired setting.
- To lock off the on/off switch press button (1) and release on/off switch (2)



For safety reasons, do not use the lock off button (1) during operation. Use only the on/off switch (2) to start and stop the Scarab Pro.

Retooling

Important Safety Precaution: Always ensure the WerkMaster Scarab is **unplugged** and the tooling has come to a complete stop before attempting to change any plates or make adjustments.

Steps for Changing Full Plates and velcro backed **Ensure Safety:** Disconnect the power tool from the power source and wait for all moving parts to cease.

1. **Grasp Tooling:** Firmly grasp the (1) Plug 'N Go tooling segment or (2) Resin Pad you wish to remove.
2. **Detach:** The Plug 'N Go tooling is secured by velcro and two shear pins that align with the (3) pad driver. You can typically remove the tooling by hand.
3. **Attach New Tooling:** Align the two shear pins of the new Plug 'N Go tooling plate with the corresponding holes on the Scarab's pad driver.
4. **Verify Seating:** Ensure that each tooling piece is flush to the plate to ensure proper operation and even wear.

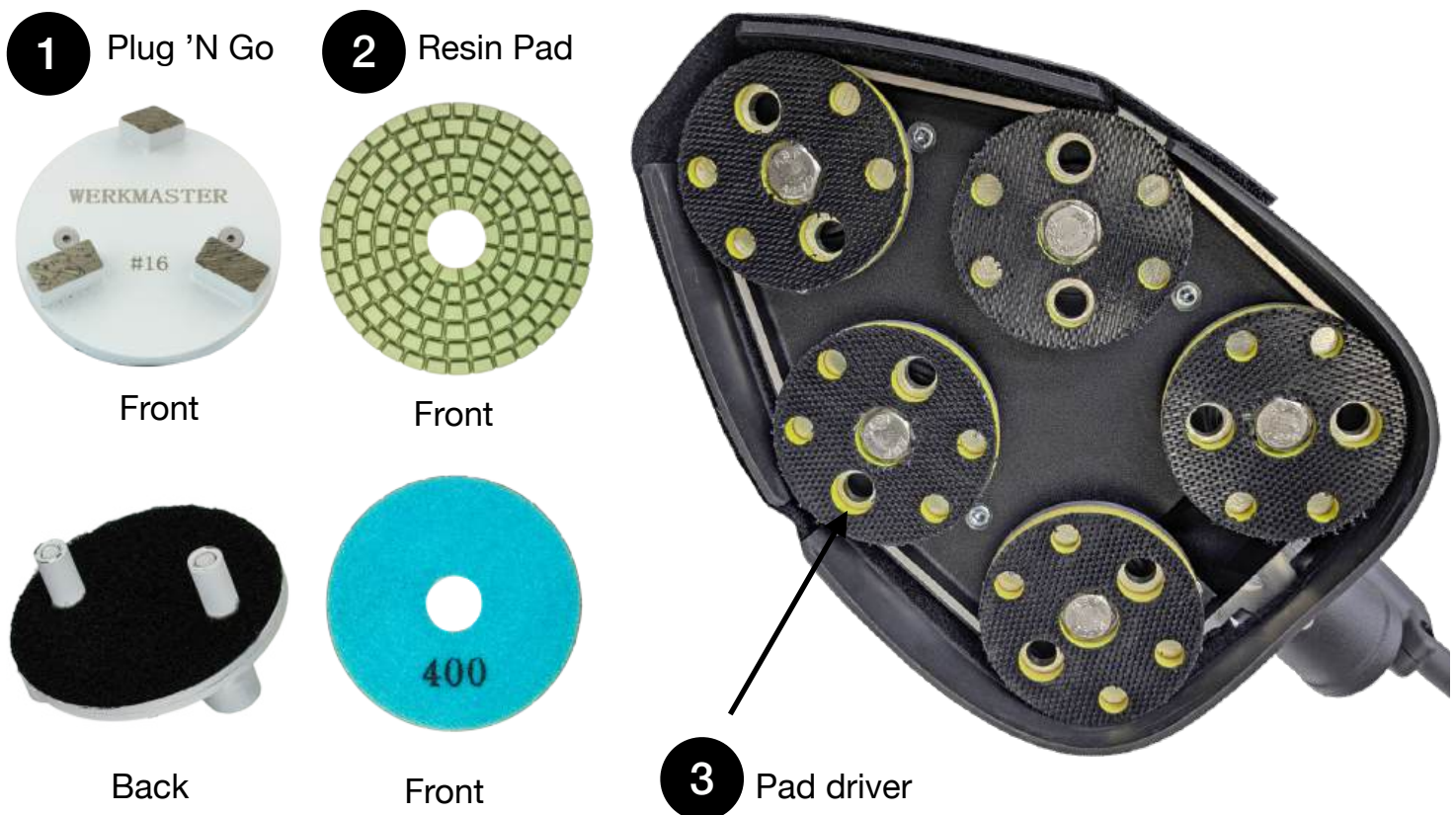

Removing Pad Driver

Please follow these instructions to change the pad driver on your Scarab Pro:

1. **Disconnect Power:** Ensure the Scarab Pro is disconnected from its power source prior to commencing any work.
2. **Access Pad Driver:** Gently **peel back the dust skirt (2)** to expose the pad driver and the output shaft.
3. **Secure Output Shaft:** Utilize the **supplied wrench (1)** to firmly hold the output shaft in place. Spin the pad driver (5) by hand to until wrench(1) locks firmly on output shaft.
4. **Remove Pad Driver Bolt:** Using a 17mm socket, carefully remove the pad driver bolt (4).

Once the bolt is removed, the pad driver can be detached. Add semi-permanent thread locker. Ensure pad driver (5) aligns with output shaft. Reverse these steps to install the new pad driver securely.

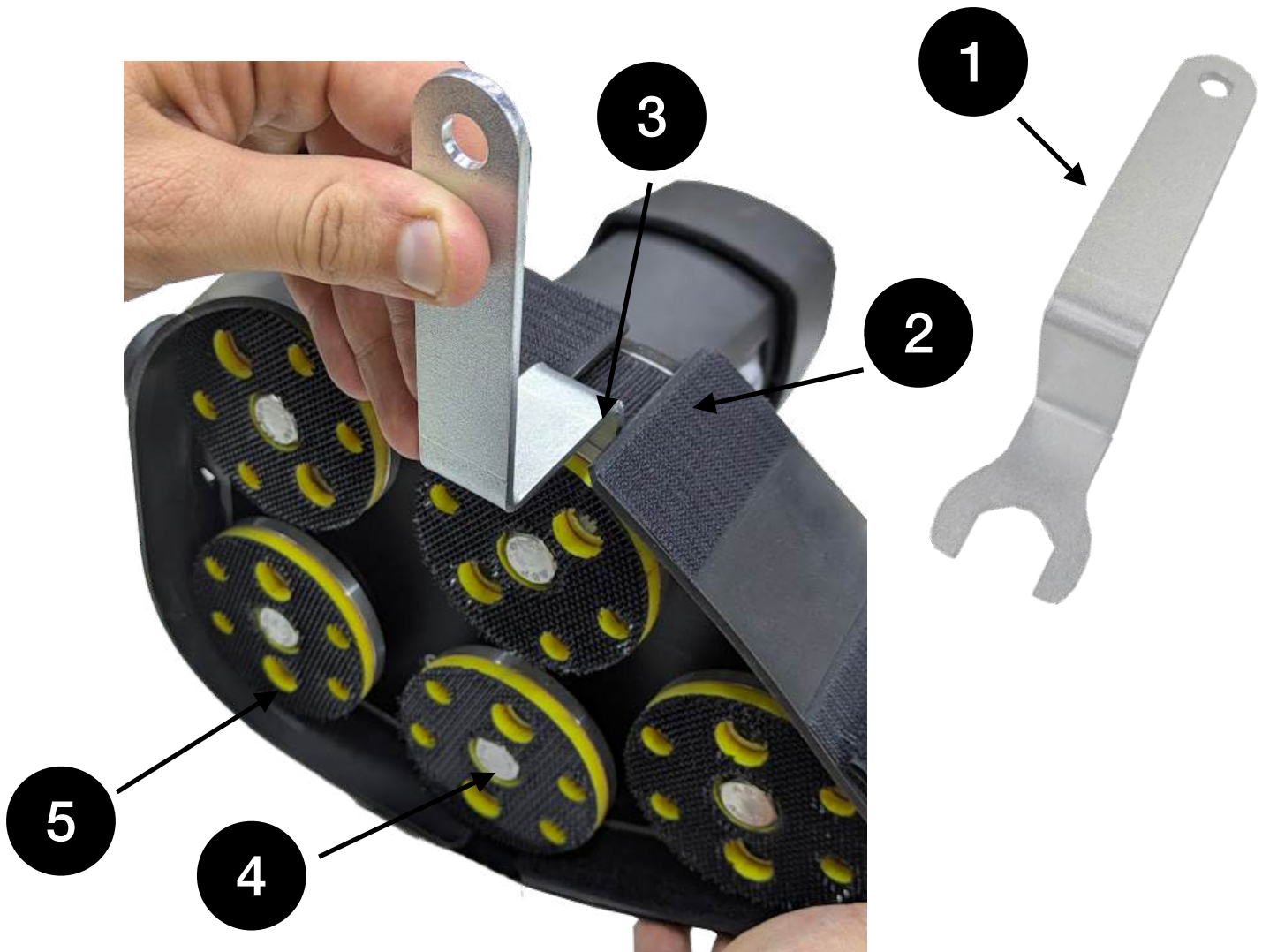

Dust Control Adapter

- The **WerkMaster Scarab Pro** includes a **(1) vacuum port adapter**. To use it, attach it to the back of the machine as illustrated in the provided picture.

