

# Jrco

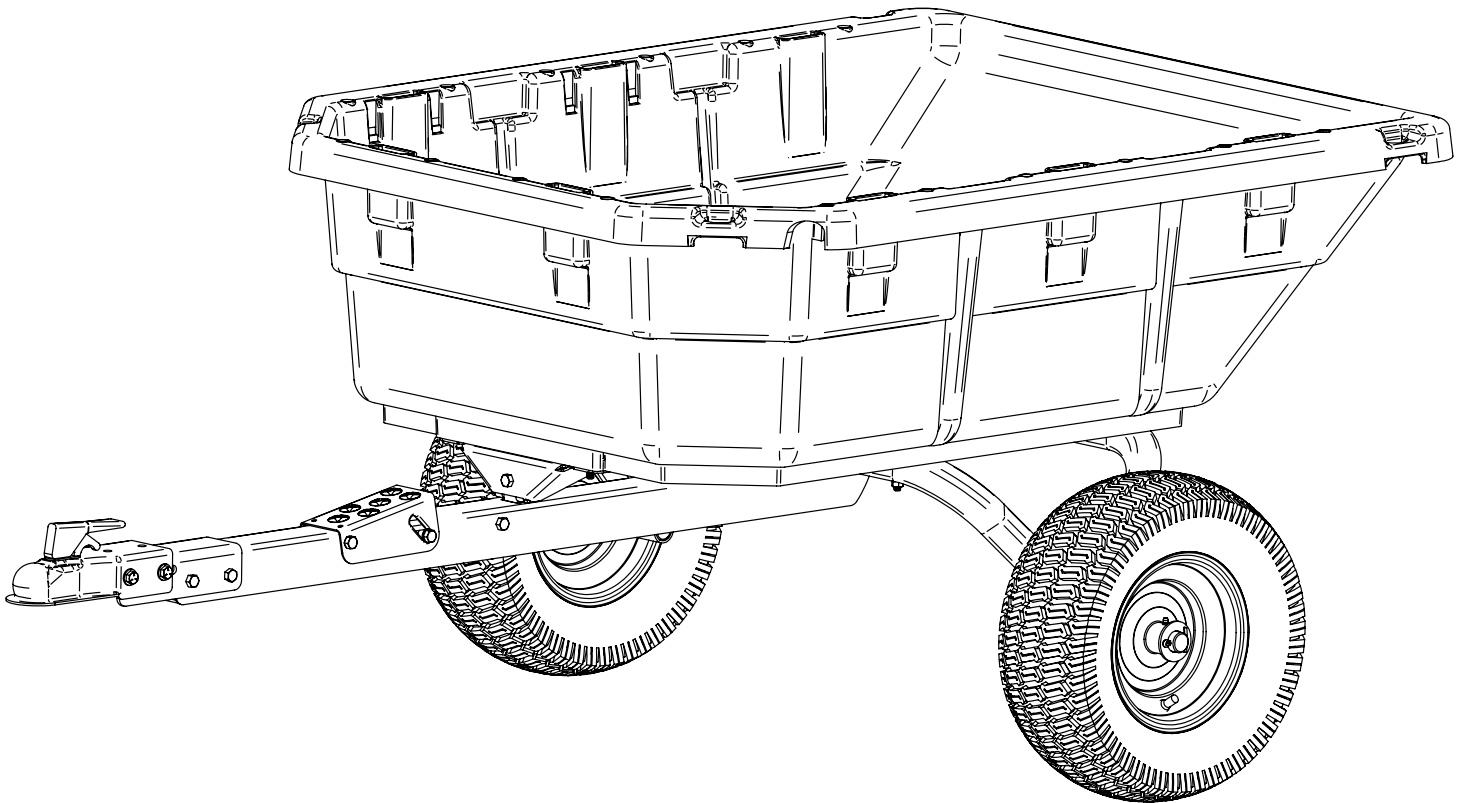

## **GWG311139**

### **15 cu ft POLY SWIVEL ATV DUMP CART**

U.S. Patent No. 8,496,298 9,056,573 9,242,588



**READ AND FOLLOW ALL SAFETY RULES AND OPERATING  
INSTRUCTIONS BEFORE USING THIS EQUIPMENT**

# ***Safety Rules***



**This is the safety alert symbol. It is used to alert you to potential personal injury hazards. Obey all safety messages that follow this symbol to avoid possible injury or death.**

Read and understand all safety rules and operating instructions before using this ATV/UTV attachment.

Follow all safety rules and operating instructions provided by your vehicle's manufacturer when using attachment.

Never allow children or untrained persons to operate vehicle or attachment.

Do not exceed the vehicle manufacturer's towed weight limit.

Reduce vehicle speed and allow extra stopping distance when towing heavy loads.

Reduce vehicle speed and towed weight when operating on slopes.

Operate up and down slopes, never across the face of slopes.

Do not carry passengers on vehicle or attachment.

Avoid sudden turns or maneuvers.

Do not tow attachment on public roadways.

Do not remove warning decals from product.

Check product for worn, loose, or damaged parts before each use. If any damage is present, repair the product before using.

Check product for loose or missing fasteners before each use. Tighten or replace fasteners as needed before using.

Do not exceed vehicle speed of 20 miles per hour when towing Dump Cart.

Do not exceed Dump Cart rated weight capacity of 1250 pounds.

# ***Warranty***

## **IF YOU ARE MISSING PARTS DO NOT RETURN TO STORE**

Email [warranty@gnedi.com](mailto:warranty@gnedi.com) or call 1-866-297-4918

**Attach Receipt Here:**

**Before you call, please email our customer service team at [warranty@gnedi.com](mailto:warranty@gnedi.com) with the following:**

1. A description of the issue you are experiencing.
2. Photos of the issue that include an overall view and detailed view from multiple angles.
3. If applicable, a short video showing the issue.

### **Replacement Parts:**

**You can place your parts order online at [www.gnedi.com](http://www.gnedi.com).**

- You can also reach our Repair Parts Team at 1-855-388-9848.
- If you are ordering replacement part(s) for your product, please note that some parts are only available as a repair kit.

If this product fails due to a defect in material or workmanship within THREE YEARS from the date of purchase, we will at our option, only with receipt of purchase, repair or replace it free of charge. This warranty excludes tires, wheels, brushes and bag, which are expendable and become worn during normal use.

### **This warranty does not cover:**

- Repairs necessary because of operator abuse or negligence.
- Equipment used for commercial or rental purposes.
- Paint that is worn or faded due to normal use or exposure.
- Product degradation or failure due to corrosion or its effects.

To arrange for product repair visit **[www.gnedi.com](http://www.gnedi.com)** and fill out the warranty claim form. You can also call 1-866-297-4918 to speak to our Customer Service Team.

This warranty gives you specific legal rights, and you may also have other rights which may vary from state to state. This warranty applies only while this product is in use in the United States.

# Carton Contents

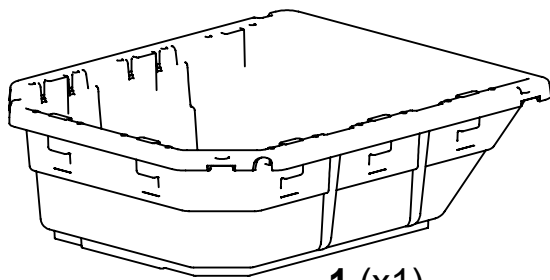

1 (x1)

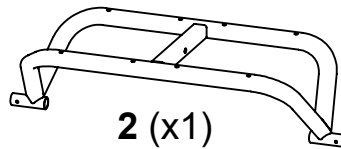

2 (x1)

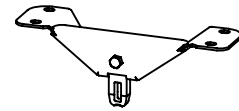

3 (x1)

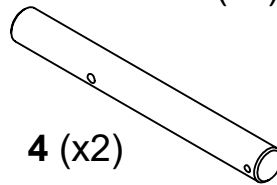

4 (x2)

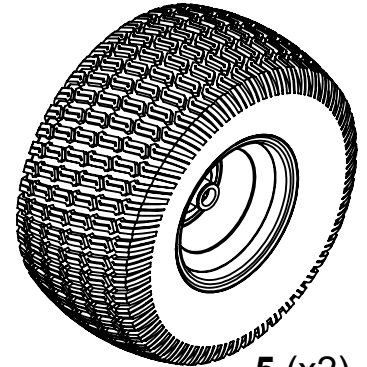

5 (x2)

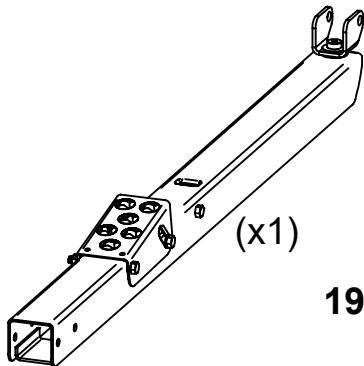

(x1)

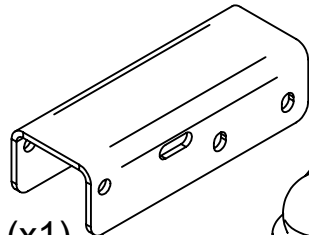

19 (x1)

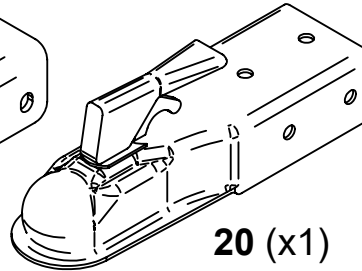

20 (x1)

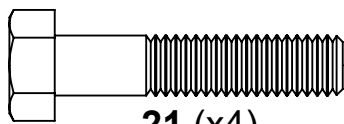

21 (x4)

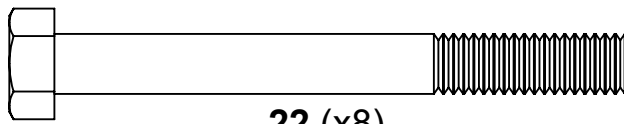

22 (x8)

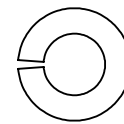

23 (x12)

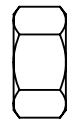

24 (x12)

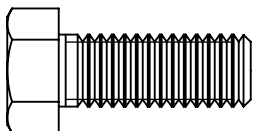

25 (x4)

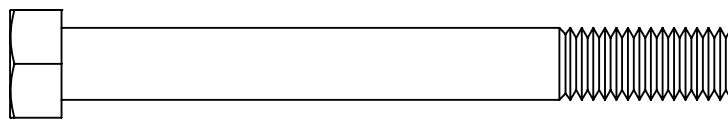

26 (x2)

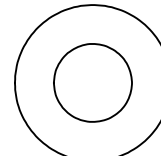

27 (x8)

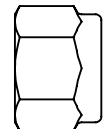

28 (x6)

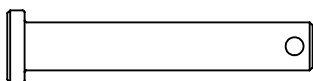

29 (x2)



30 (x2)

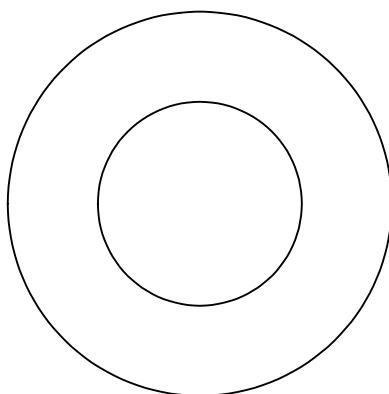

31 (x4)

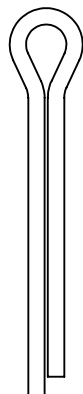

32 (x2)

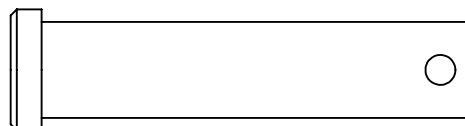

33 (x1)

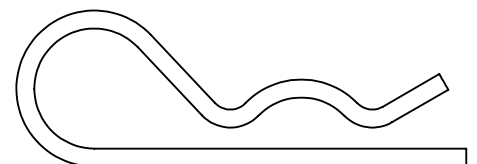

34 (x1)

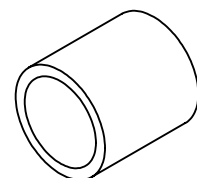

35 (x2)

## TOOLS REQUIRED FOR ASSEMBLY:

- 1/2" Wrench and Socket
- 9/16" Wrench and Socket
- Needle-Nose Pliers
- Grease Gun

# Assembly Instructions

**1**

Hold Poly Body (1) on side as shown. Insert Hex Bolts (21 & 22) as shown.

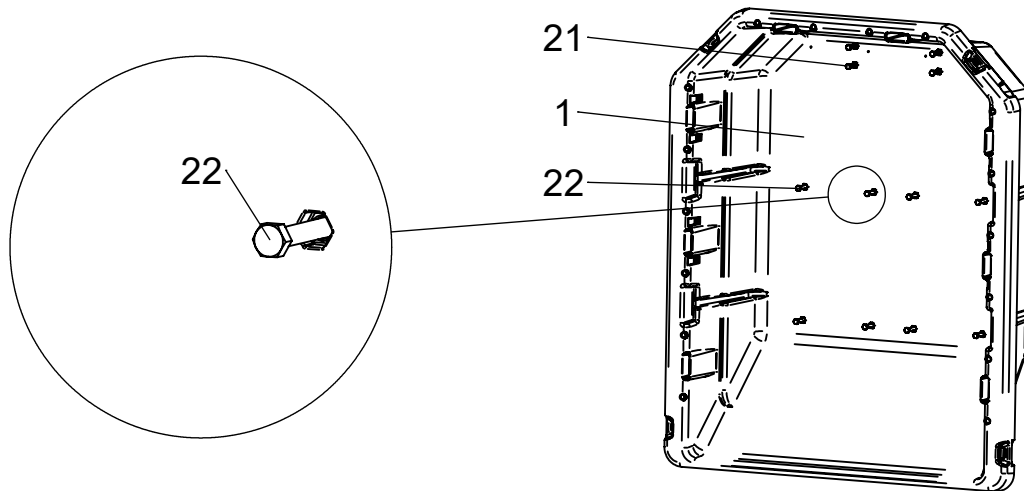

**2**

Flip Poly Body (1) to expose bolts.

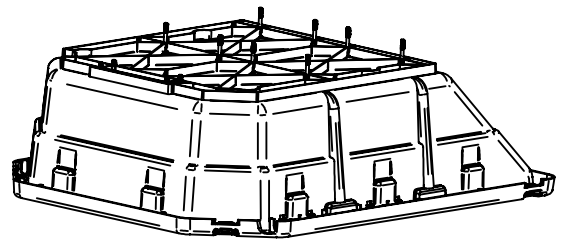
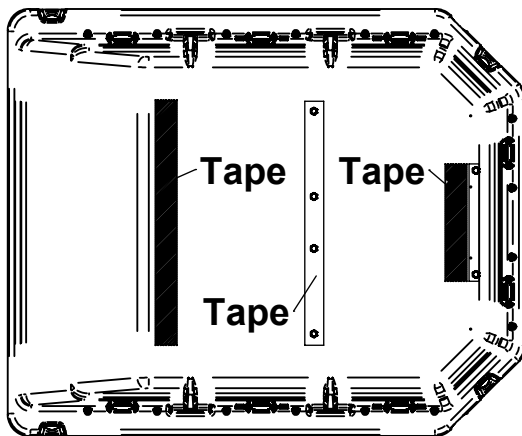

**TIP: Bolt heads can be secured with tape to aid in assembly.**

**3**

Install Undercarriage (2) over top of Hex Bolts (22). Install and tighten all Hardware (23 & 24).

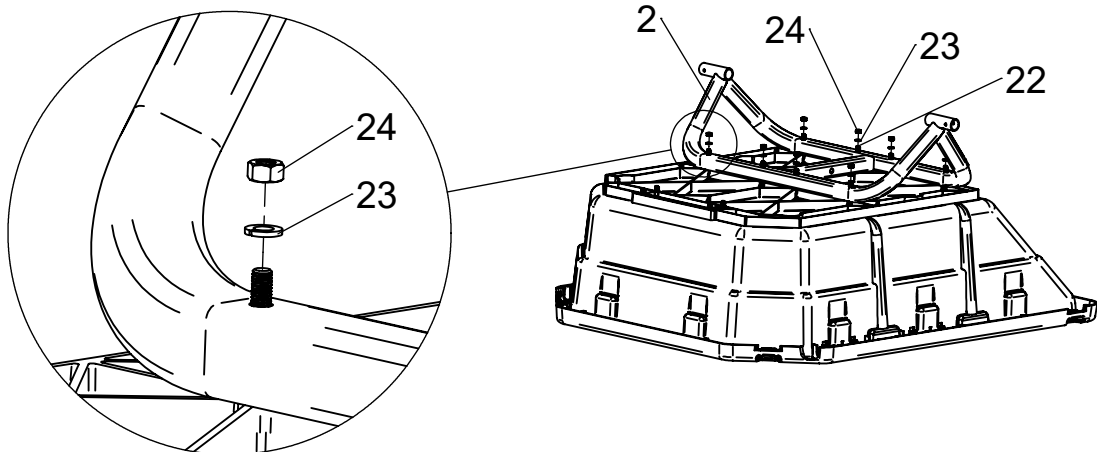

# Assembly Instructions

**4**

Install Front Support (3) over top of bolts (21). Intall and tighten Hardware (23 & 24).

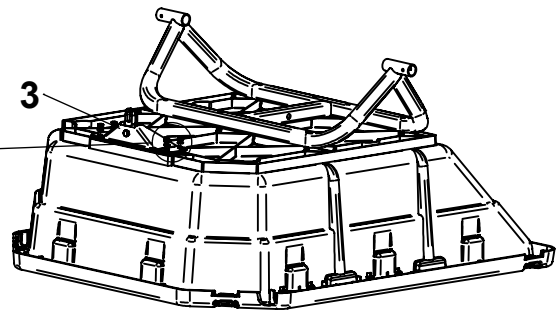
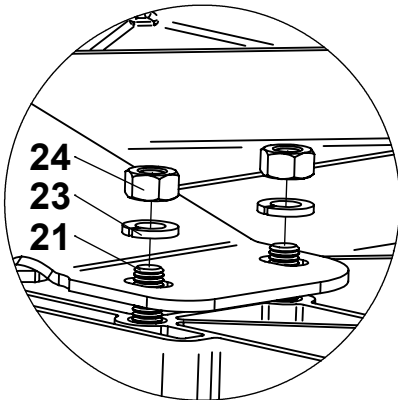

**5**

Insert Stub Axles (4) into Undercarriage (2) and secure with Pins (29 & 30) as shown.

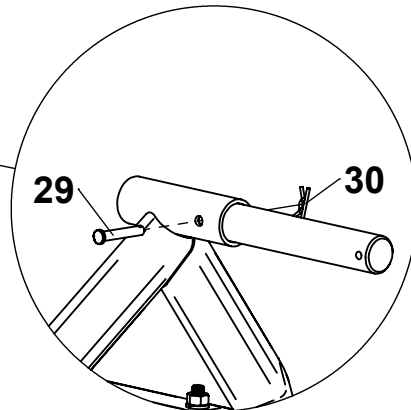
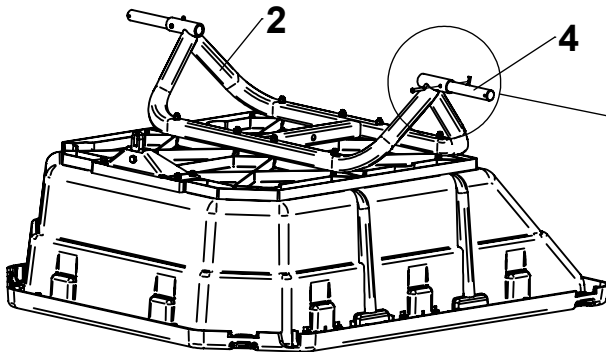

**6**

Slide Washers (31), Spacers (35), and Wheels (5) onto Stub Axles (4) and install Cotter Pin (32). Bend legs of Cotter Pin (32) to secure Wheel (5).

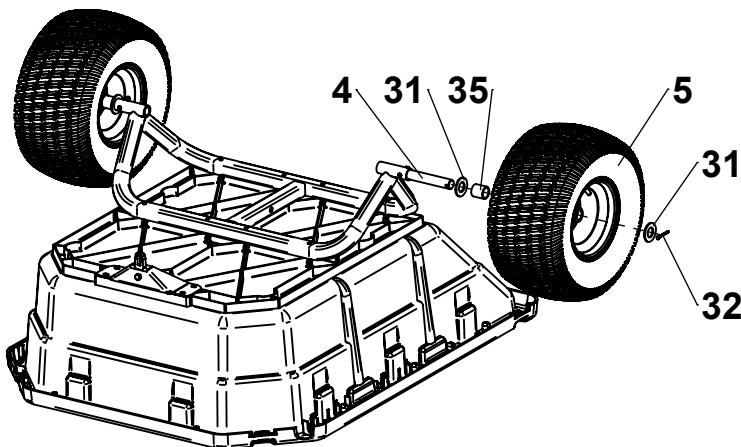

# Assembly Instructions

**7**

Align holes in Swivel Clevis (8) and Undercarriage (2) and install Pin (33) as shown. Secure Pin with Hairpin (34).

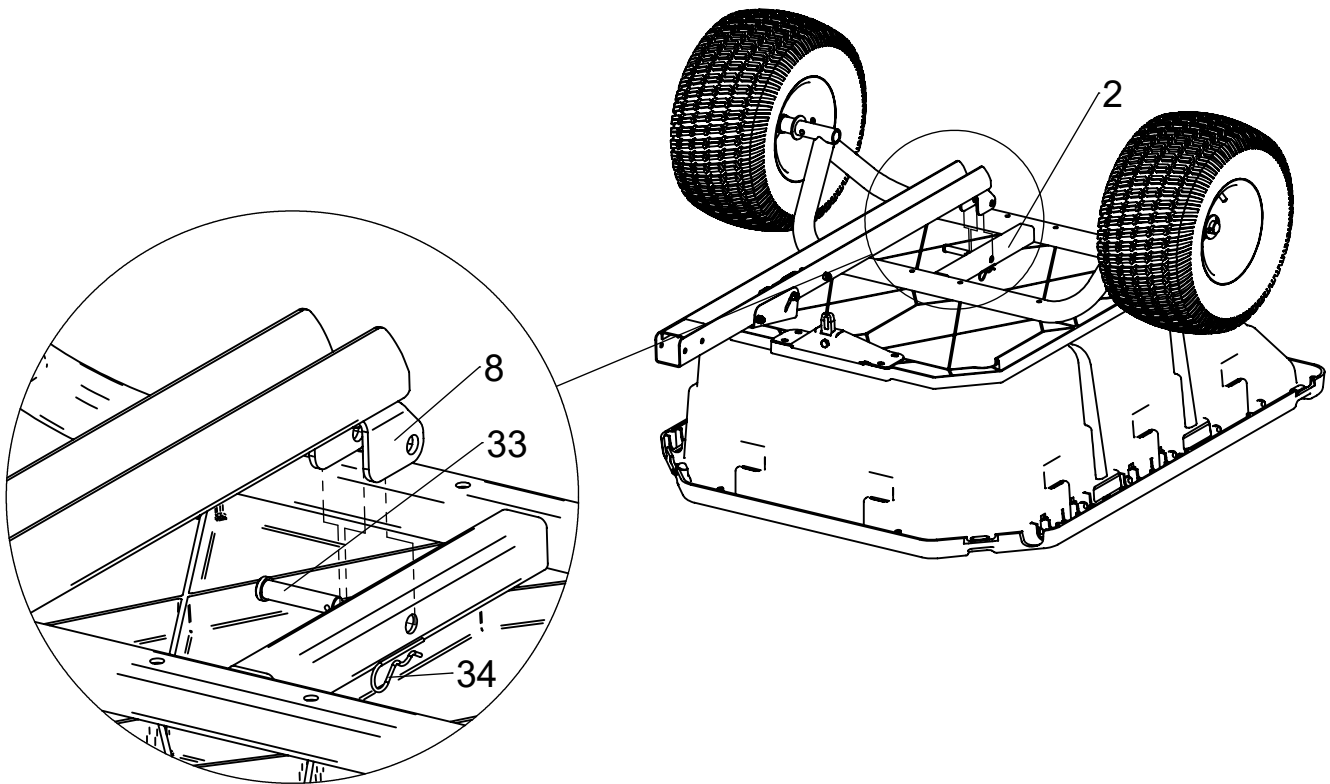

**8**

Attach Ball Coupler (20) to Bracket (19) and tighten hardware (25, 27, & 28) as shown. Then attach Bracket (19) to Drawbar (6) with hardware (26 & 28) and tighten.

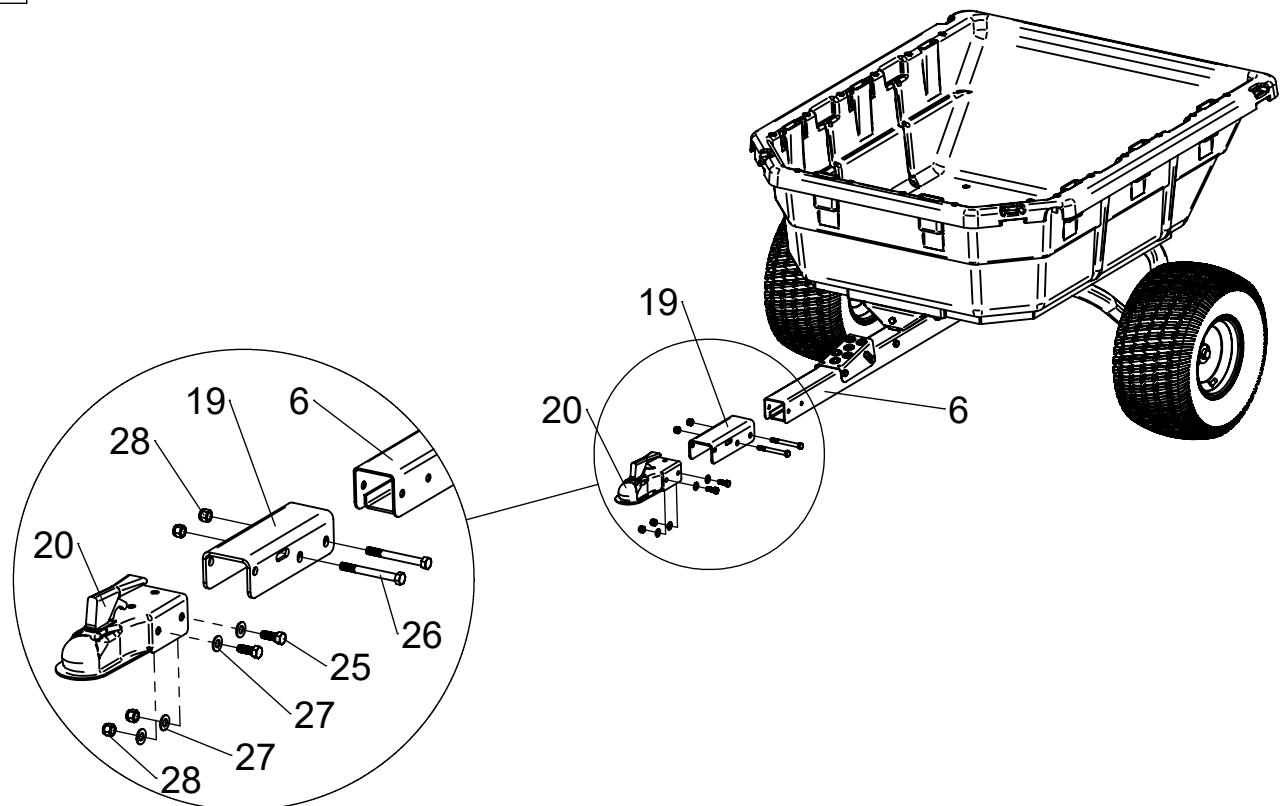

# ***Operating Instructions***

## **Before Using Dump Cart:**

1. Apply lithium grease to wheels using grease gun until grease can be seen squeezing out from both sides of the wheel.
2. Check tire pressure and inflate to 24 psi if needed.
3. Read all Safety Rules found on page 1.

## **How to Use Dump Cart:**

1. Attach Dump Cart to your ATV or UTV.
2. Do not exceed 1250 pounds when loading material into the cart body.
3. Distribute the weight of the load as evenly as possible in the cart body for best handling.
4. When hauling heavy loads, verify that your vehicle has adequate towing and braking capacity.
5. Do not exceed 20 miles per hour when towing Dump Cart.

## **How to Empty Dump Cart:**

1. Step down the foot pedal to release the latch mechanism.
2. Lift the body and swivel as desired to guide the material to preferred location.
3. Lift the body entirely and empty material.
4. Lower the body and guide the latch into the drawbar and relatch.

## **Periodic Maintenance:**

- Tighten fasteners as needed before each use
- Check tire pressure before each use
- Grease wheels annually



# Do-It-Yourself Accessories

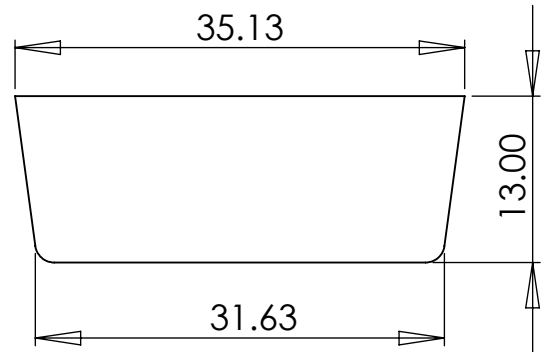
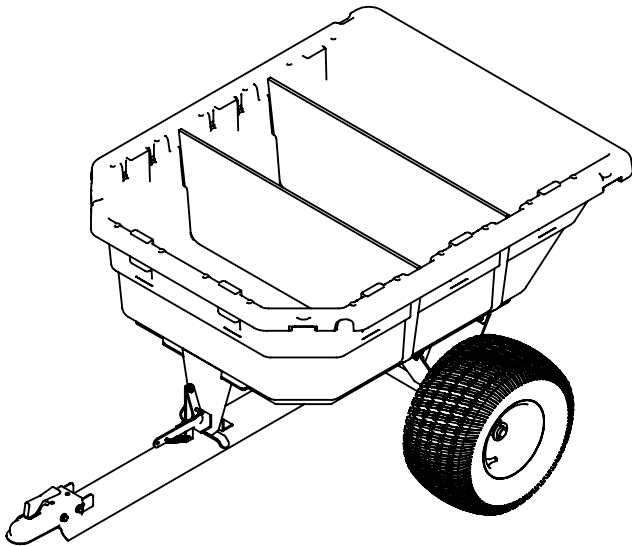

USE 1/2" PLYWOOD

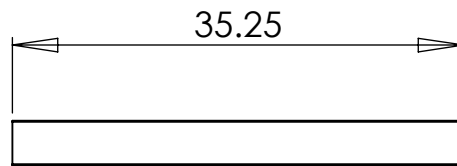
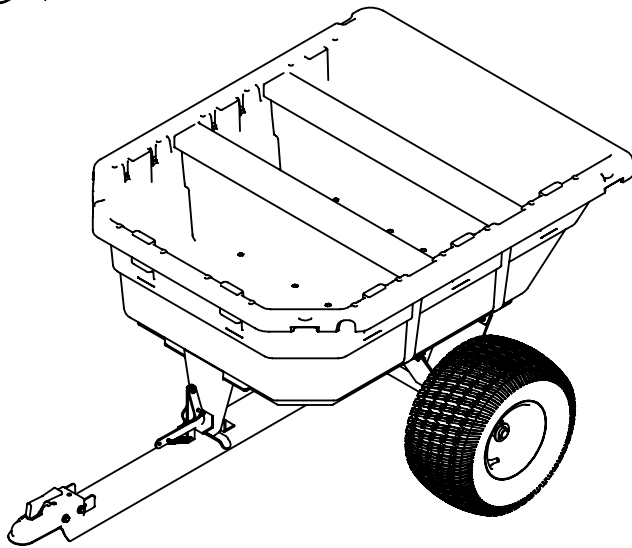

USE STANDARD 2 X 4

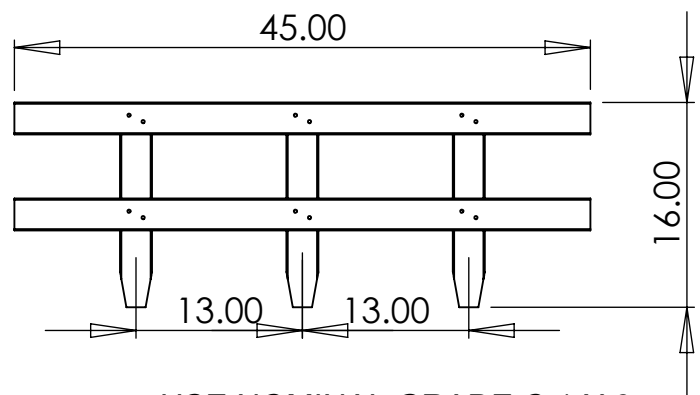
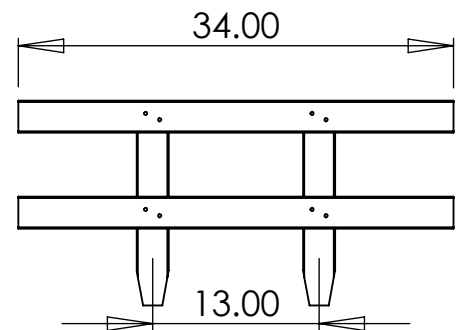
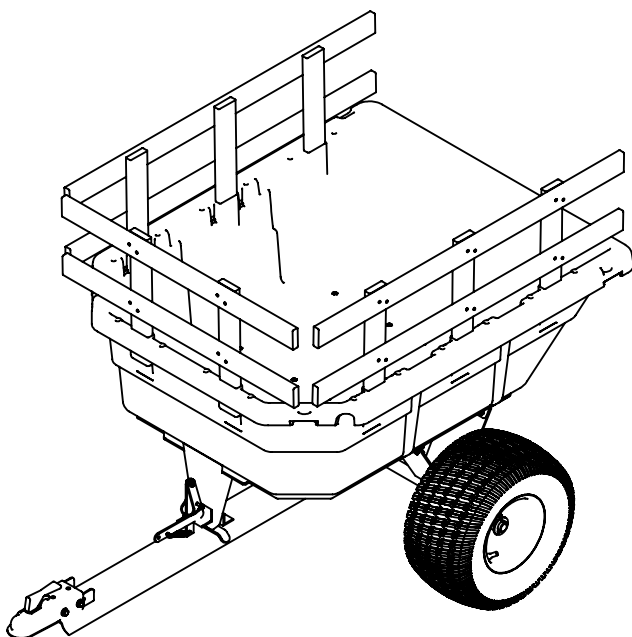

USE NOMINAL GRADE C 1 X 3

# Exploded View

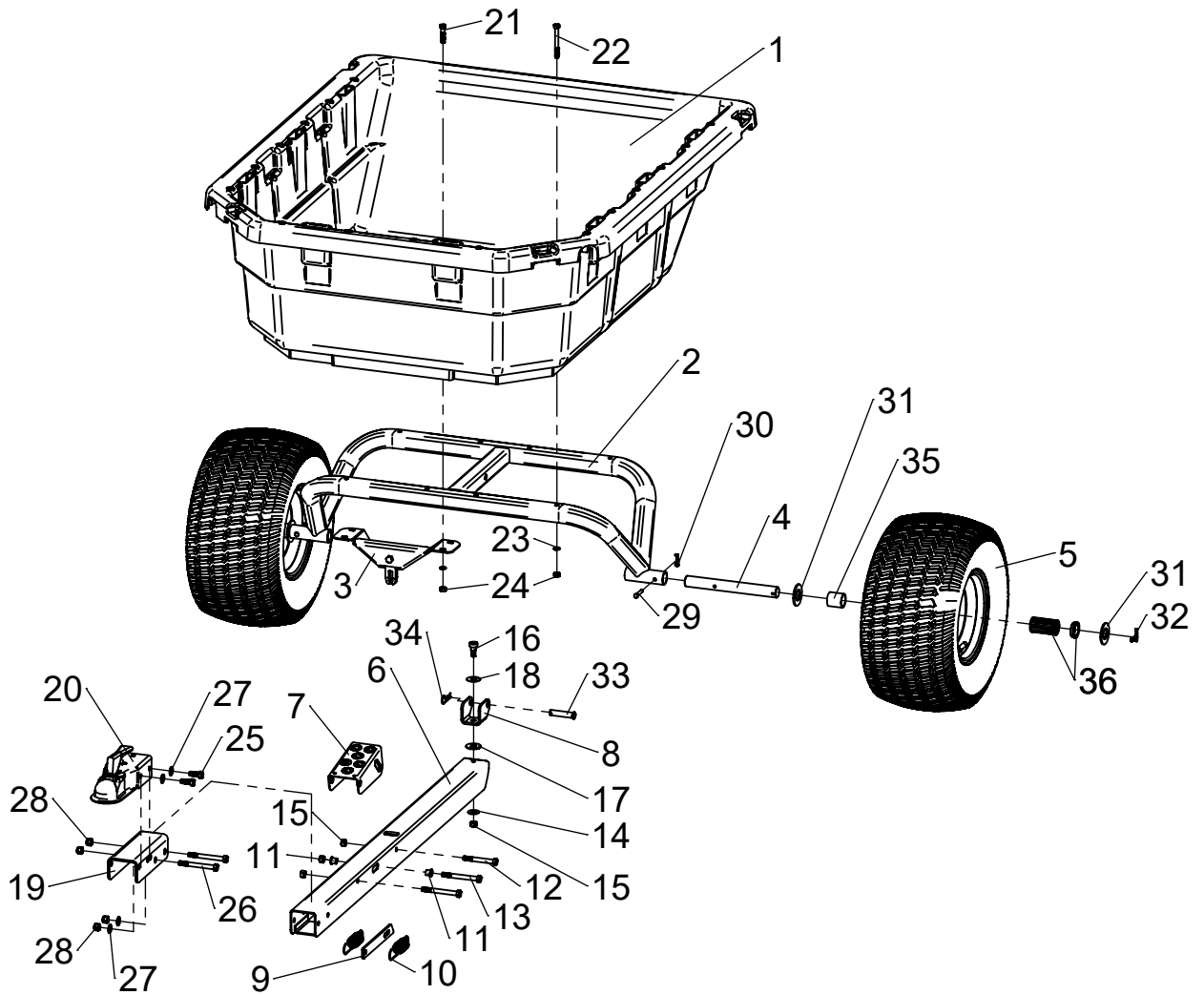

ITEM	PART NO	DESCRIPTION	QTY	ITEM	PART NO	DESCRIPTION	QTY
1	GPR300027	BODY, STRUCTURAL FOAM	1	20	GPR300038	COUPLER, 2" BALL	1
2	GPR300045	UNDERCARRIAGE, HYB	1	21	GPR300040	HEX BOLT, 5/16-18 X 1-1/2"	4
3	GPR300044	SUPPORT, FRONT, HYB	1	22		HEX BOLT, 5/16-18 X 3"	8
4	GPR300036	AXLE, 1" X 9.063"	2	23		LOCKWASHER, 5/16"	12
5	GPR300046	WHEEL, 16X7.5-8 X 1"	2	24		HEX NUT, 5/16-18	12
6	GPR300039	DRAWBAR, HYB	1	25		HEX BOLT, 3/8-16 X 1"	4
7		FOOT PEDAL	1	26		HEX BOLT, 3/8-16 X 3-1/2"	2
8		CLEVIS, SWIVEL, HYB	1	27		WASHER, 3/8" SAE	8
9		LATCH, SWIVEL DUMP	1	28		LOCKNUT, 3/8-16	6
10		SPRING, LATCH, 4-3/4"	2	29		CLEVIS PIN, 1/4" X 1-1/2"	2
11		BUSHING, FOOT PEDAL	2	30		HAIRPIN COTTER, 1-3/16"	2
12		HEX BOLT, 3/8-16 X 3"	1	31		WASHER, 1" SAE	4
13		HEX BOLT, 3/8-16 X 3-1/2"	2	32		COTTER PIN, 3/16" X 1-1/2"	2
14		WASHER, 3/8" USS	1	33		PIN, CLEVIS, 1/2" X 2"	1
15		HEX NUT, 3/8-16 C-LOCK	4	34		COTTER HAIRPIN, 3/32" X 2-5/16"	1
16	GPR300037	SHOULDER BOLT, 1/2" X 3/8"	1	35	GPR300043	SPACER	2
17		WASHER, 1/2" USS	1	36	GPR300041	KIT, 1" WHEEL BEARINGS (REPLACEMENT SET FOR 2 WHEELS)	-
18		WASHER, SPRING, 1/2"	1				
19	GPR300037	BRACKET, COUPLER	1				

## ***Notes***

# Jrco



**MODEL # GWG311139**